

MAINTENANCE OF TURBINES



Refer to the product's instructions for use for the full cleaning and sterilization maintenance procedures. This medical device is supplied in "non-sterile" condition. Please ensure that this procedure is followed before the device is used.

GENERAL CAUTION

⊘ Do not immerse the instrument in a NaCl bath or in an ultrasonic cleaner.

1 PREPARATION



A. REMOVING THE BUR

- Remove the rotary bur from the chuck mechanism.

2 PRELIMINARY CLEANING

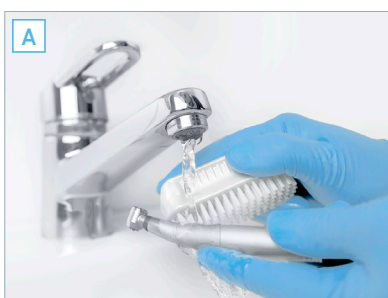

A. RINSING THE DEVICE

- Clean the exterior and the interior of the device under tap water.



B. REMOVING DIRT/DEPOSITS

- Dry the nozzles then the rest of the instrument with a sterile non-woven compress (low linting textiles).

3 DISINFECTION



A. CLEANING AND DISINFECTION

- Dip the device in a bath containing a cleaning product/disinfectant.
- Brush the device with a smooth, flexible brush. DO NOT USE a wire brush.
- Rinse the device twice under running tap water.



B. OPTIONAL: AUTOMATIC DISINFECTION

- Carry out automatic washing or cleaning/disinfection.**
- After cleaning/disinfection, check that there are no detergent residues and, if required, rinse again.
- After cleaning/disinfection, check that the device is dry. If required, manually dry the device (see 4).

***For more information, please refer to the manufacturer instructions for use*

MAINTENANCE OF TURBINES

4 MANUAL CLEANING AND DRYING



A. INTERNAL AND EXTERNAL CLEANING AND DRYING WITH SPRAYNET

- Shake the **Spraynet** before use.
- Select the appropriate **Spraynet** nozzle ①*
- Keep the tip of the instrument pointing down and protect it with a sterile non-woven cloth.
- Activate the **Spraynet**.

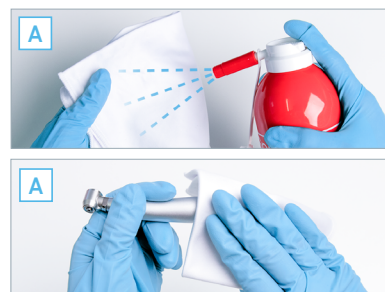

- Dry the exterior of the turbine with a cloth soaked in **Spraynet**.

⚠ Always dry the device.

5 LUBRICATION

A. LUBRICATION WITH LUBRIMED



(For 2-/3-way and 4-way turbines, see inset below)

OR B. LUBRICATION WITH LUBRIFLUID

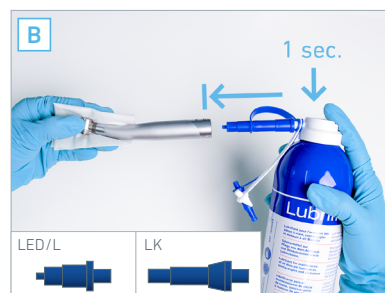

- Shake the **Lubrifluid** before use.
- Use the **Lubrifluid** attachment ①*
- Select the appropriate **Lubrifluid** nozzle ②*
- Keep the tip of the instrument pointing down and protect it with an absorbent cloth.
- Activate the **Lubrifluid**.

MAINTENANCE OF TURBINES

FOR 2-/3-WAY AND 4-WAY TURBINES ONLY

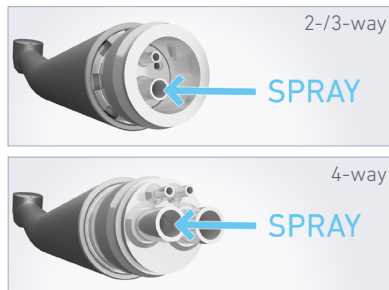

B'. INTERNAL LUBRICATION WITH LUBRIFLUID FOR 2-/3-WAY AND 4-WAY TURBINES ONLY

- Use the **LubrifiLuid** attachment ①*
- Select the appropriate **LubrifiLuid** nozzle ③*
- Keep the tip of the instrument pointing down and protect with an absorbent cloth; press the **LubrifiLuid** button down for 1 second.

△ Spray into the opening as shown in the illustrations for "2-/3-way" and "4-way".

6 STERILIZATION



A. PLACE THE TURBINE IN A STERILIZATION BAG



B. STERILIZE IN ACCORDANCE WITH THE MANUFACTURER'S INSTRUCTIONS

- Only instruments bearing the  symbol can be sterilized in an autoclave.

△ Only sterilize instruments which have been properly cleaned, dried and lubricated.

*All the attachments are shown on the last page of this document.

You can download the full instructions from: <https://dental.bienair.com/ifu>

MAINTENANCE

ACCESSORIES



SPRAYNET
500 ml cleaning spray
Pack of 6
REF. 1600036-006



LUBRIFLUID
500 ml lubricant
Pack of 6
REF. 1600064-006



LUBRICARE 2
Maintenance system
REF. 1601156-001



LUBRIMED
Pack of 6
REF 1600037-006