

# Hoses MC2 & Isolite

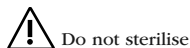

## Instruction

REF 2100017-ENG/09.11

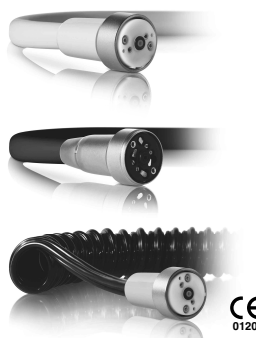

### English

Medical devices entirely made in Switzerland by Bien-Air Dental SA.

### Type

Electric micromotor hose with revolving connector for use with the MC2, the Isolite 100 and 300, with or without light. Quality hoses straight or coiled, in black, grey or white. Standard length 1.7 m or special lengths up to 3 m.

### Intended use

Product intended for professional use only. Use in dentistry for prophylaxis, general dentistry and endodontic work.

### Technical data and assembly

#### Classification

Class IIa, « active medical devices », as per section III « Classification », Rule 2 of Annex IX to European Directive 93/42/EEC, namely: « Non-invasive devices intended for channelling liquids or gases for the purpose of administration into the body, which may be connected to an active medical device in Class IIa ».

#### Fitting

Keep the initial alignment of the leads and conduits unchanged. Place the back-up ring ⑧ in the locking area fig. 1. Tie the security string ⑨ fig. 2.

#### Description fig. 3 - 4

- ① Ø 1.5/2.5 mm air spray (small white) with "A" or (blue)
- ② Ø 1.5/2.5 mm water spray (small white) with "W" or (green)
- ③ Ø 1.5/2.5 mm motor cooling (small white) or (transparent) Ø 2.8/4.1 mm
- ④ (+) red: motor
- ⑤ black: motor
- ⑥ (+) brown: bulb
- ⑦ (0V) blue: bulb
- ⑧ back-up ring
- ⑨ security string (if existing)

#### Accessories

O-Ring joint REF 1300414-010. Changing the O-ring joint fig. 5. The split ring REF 212.65.01 fig. 6 is required only for connection to an MC2 IR or GTAV motor fig. 7-8.

Connection (without the split ring) to an Isolite electric motor fig. 9-10.

The conical piece fig. 11 can be useful for connecting the cooling tube to the Unit tube ⑦ fig. 12.

### Maintenance



#### Cleaning

Carefully clean all surfaces with a cloth impregnated with Spraynet, fig. 13.

#### Disinfection

Disinfect using a clean cloth soaked in a suitable product. Products containing acetone, chlorine and bleaches are not recommended as disinfectants.

To keep the surface of the hose in good condition, it is advisable to periodically wipe the complete length of it with a cloth dusted with talcum powder.

Never immerse in disinfectant solutions.

Not suitable for ultrasonic bath.

#### Transport

Temperature between -40°C (-40°F) and 70°C (158°F), relative humidity between 10% and 100%, atmospheric pressure 50 kPa to 106 kPa (7.3 to 15.3 psi).

#### Information

The technical specifications, illustrations and dimensions contained in these instructions are given only as a guide. They may not be the subject of any claim. The manufacturer reserves the right to make technical improvements to its equipment, without amending these instructions. For all additional information, please contact Bien-Air Dental SA at the address indicated on the back cover.

#### Other precautions for use

The device must be used by a qualified person in accordance with the current legal provisions concerning industrial safety, health and accident prevention measures, and these working instructions. In accordance with these requirements, the operators:

- must only use operating devices that are in perfect working order; in the event of irregular functioning, excessive vibration, abnormal heating or other signs indicating malfunction of the device, the work must be stopped immediately; in this case, contact a repair centre that is approved by Bien-Air Dental;
- must ensure that the device is used only for the purpose for which it is intended, must protect themselves, their patients and third parties from any danger, and must avoid contamination through the use of the product.

The device is intended for medical treatment only; any use other than that for which this product is intended is unauthorised and may be dangerous. The medical device meets all the current legal requirements.

The device is not authorised for use in an explosive atmosphere (anaesthetic gas).

#### Recommendations

It is essential to use dry, purified compressed air in order to ensure the long working life of the device. Maintain the quality of the air and the water by regular maintenance of the compressor and the filtration systems. The use of unfiltered hard water will lead to early blockage of the tubes, connectors and spray cones.

Rest the device on a suitable support to avoid risks of infection for yourself, the patient or third parties.

Only use maintenance products and components from Bien-Air Dental. The use of other products and components can void the guarantee.

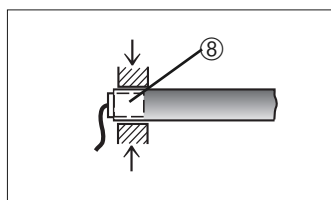

fig. 1

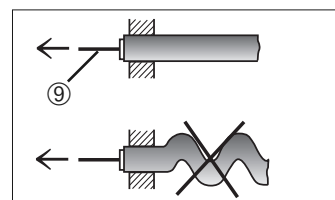

fig. 2

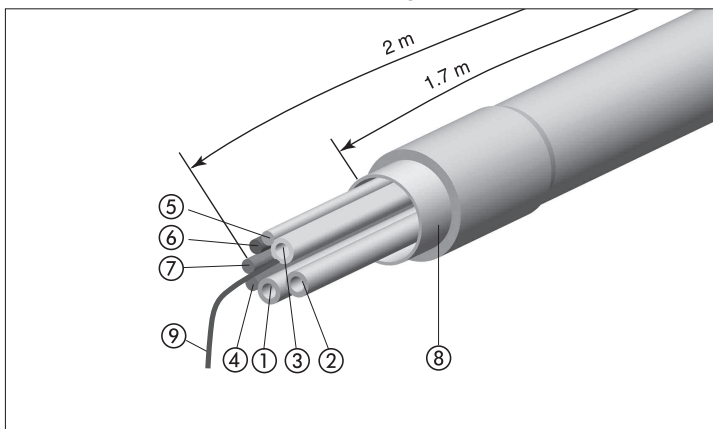

fig. 3

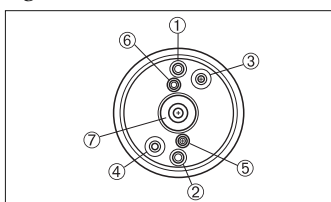

fig. 4

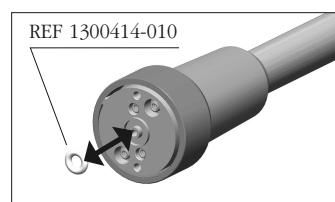

fig. 5

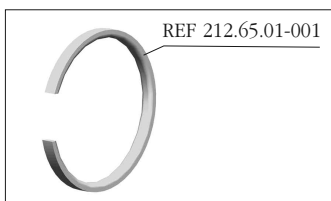

fig. 6

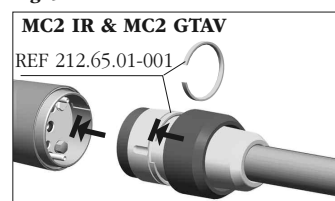

fig. 7

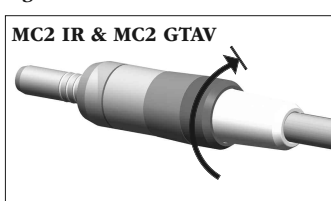

fig. 8

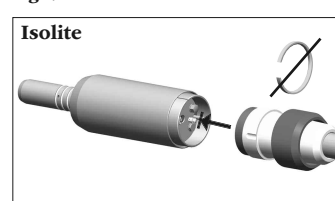

fig. 9

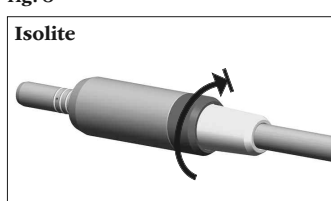

fig. 10

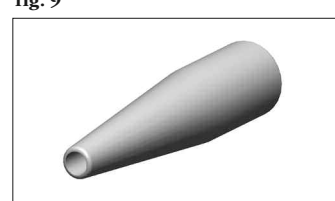

fig. 11

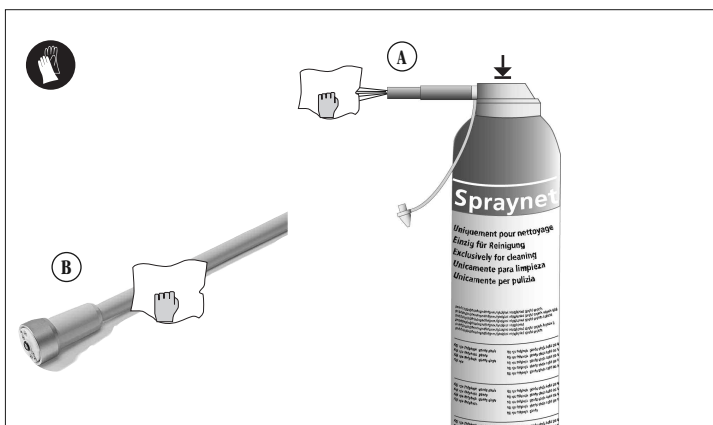

fig. 13

## Guarantee

### Terms of guarantee

Bien-Air Dental grants the user a guarantee covering all functional defects, material or production faults. The device is covered by this guarantee for 12 months from the date of invoicing.

Bien-Air Dental offers a 24-month guarantee for the glass-bar light conductors.

In the event of justified claim, Bien-Air Dental or its authorised representative will fulfil the company's obligations under this guarantee by repairing or replacing the product free of charge. Any other claims, of whatever nature, in particular in the form of a claim for damages and interest, are excluded.

Bien-Air Dental shall not be held responsible for damage or injury and the consequences thereof, resulting from:

- excessive wear and tear
- improper use

- non-observance of the instructions for installation, operation and maintenance
- unusual chemical, electrical or electrolytic influences
- poor connections, whether of the air, water or electricity supply.

The guarantee does not cover flexible "fibre optic" type conductors, or any parts made of synthetic materials.

The guarantee shall become null and void if the damage and its consequences are due to improper manipulation of the product, or modifications to the product carried out by persons not authorised by Bien-Air Dental.

Claims under the terms of the guarantee will be considered only on presentation, together with the product, of the invoice or the consignment note, on which the date of purchase, the product reference and the Serial No. should be clearly indicated.

Designation micromotor	MC2 40 IR	MC2 40 GTAV	MC2 Isolite 300	MC2 Isolite 100
REF micromotor	1600073-001	1600075-001	1600078-001	1600079-001
Designation hose	REF hose			
Grey hose with fixed connector	1600120-001	x	(x)	x
Black hose with fixed connector	1600297-001	x	(x)	x
Grey hose, revolving connector	1600298-001		x	x
Black hose, revolving connector	1600299-001		x	x
White hose with fixed connector	1600314-001	x	(x)	x
Black coiled hose with fixed connector	1600315-001	x	(x)	x
White hose, revolving connector	1600316-001		x	x

(X) Do not connect supply of water and air spray (risk to damage the micromotor)

This product may be covered by one or more of the following patents:

**EP Europe:** 745358 / 688539 / 948294 / 1145688 / 1563800 / 1563801 / 1675523 / 1753360 **DE Germany:** 29616023-7  
**DK Denmark:** 9600315 **FR France:** 2722972 **CH Switzerland:** 693922 **CN China:** 100528099 / 100522100 / 100522099 / 100553584 **JP Japan:** 3892485 / 4298933 / 7000419 **US United States:** 5453008 / 6033220 / 6319003 / 7214060 / 7448870  
**RU Russia:** 2361540 / 2361541 / 2372046

REF 1600120-001 HOSE ISOLITE/MC2 GREY / REF 1600297-001 HOSE ISOLITE/MC2 BLACK / REF 1600314-001 HOSE ISOLITE/MC2 WHITE / REF 1600315-001 HOSE ISOLITE/MC2 COILED BLACK / REF 1600298-001 HOSE ISOLITE/MC2 SWIVEL GREY / REF 1600299-001 HOSE ISOLITE/MC2 SWIVEL BLACK / REF 1600316-001 HOSE ISOLITE/MC2 SWIVEL WHITE

## Set supplied

### Fixed connector for MC2

REF 1600120-001	
REF 1600297-001	
REF 1600314-001	
REF 1600315-001	

### Rotating connector for MC2

REF 1600298-001	
REF 1600299-001	
REF 1600316-001	

## Optional accessories

	REF 212.65.01-001	10x
	REF 1300414-010	
	REF 1600036-006	6x

REF	Legend
1600120-001	Grey hose with fixed connector, for micromotors MC2 and Isolite
1600297-001	Black hose with fixed connector, for micromotors MC2 and Isolite
1600298-001	Grey hose, revolving connector for micromotors Isolite
1600299-001	Black hose, revolving connector for micromotors Isolite
1600314-001	White hose with fixed connector, for micromotors MC2 and Isolite
1600315-001	Black coiled hose with fixed connector for micromotors MC2 and Isolite
1600316-001	White hose, revolving connector for micromotors Isolite
1300414-010	O-Ring joint
212.65.01-001	Split ring
1600036-006	Spraynet, cleaning spray 500 ml, box of 6 cans

## List of Bien-Air Dental SA registered trade mark products ®:

Aquilon®	ChiroPro®	Gyrolina®	Lubrimed®	Prestilina®
Bora®	Eolia®	Isolite®	MX®	Spraynet®
Boralina®	Gyro®	Lubrifiuid®	PowerCare®	

In these instructions, "Device" corresponds to the product described in the heading "Type". For example, turbine, contra-angle, handpiece, micromotor, tube, electronics, connectors, station etc.

## Symbols

	Manufacturer.		CE Marking with number of the notified body.
	Wear rubber gloves.		Move in the direction indicated.
	Attention.		Move fully to the stop, in the direction indicated.

**Bien-Air Dental SA**  
 Länggasse 60  
 Case postale  
 2500 Bienne 6, Switzerland  
 Tel. +41 (0)32 344 64 64  
 Fax +41 (0)32 344 64 91  
 office@bienair.com

**Bien-Air Deutschland GmbH**  
 Jechtinger Strasse 11  
 79111 Freiburg, Deutschland  
 Tel. +49 (0)761 45 57 40  
 Fax +49 (0)761 47 47 28  
 ba-d@bienair.com

**Bien-Air España, SA**  
 Entença, 169 Bajos  
 08029 Barcelona, España  
 Tel. +34 934 25 30 40  
 Fax +34 934 23 98 60  
 ba-e@bienair.com

**Bien-Air USA, Inc.**  
 Medical Technology  
 5 Corporate Park  
 Suite 160  
 Irvine, CA 92606 USA  
 Phone 1-800-433-BIEN  
 Phone 949-477-6050  
 Fax 949-477-6051  
 ba-usa@bienair.com

**Bien-Air France Sàrl**  
 55-57, avenue Jean Lolive  
 93508 Pantin Cedex, France  
 Tel. +33 (0)1 41 83 60 70  
 Fax +33 (0)1 48 96 07 40  
 ba-f@bienair.com

**Bien-Air Italia s.r.l.**  
 Via Vaina 3  
 20122 Milano, Italia  
 Tel. +39 (02) 58 32 12 51/52/54  
 Fax +39 (02) 58 32 12 53  
 ba-i@bienair.com

**Bien-Air UK Ltd**  
 Arundel House  
 Unit 1 - Ground Floor  
 Amberley Court, Whitworth Road  
 Crawley, West Sussex,  
 RH11 7XL, England  
 Telephone +44 (0)1293 550200  
 Fax: +44 (0)1293 520481  
 ba-uk@bienair.com

**Bien-Air Asia Ltd.**  
 Nishi-Ikebukuro  
 Daiichi-Seimei Bldg. 10F  
 2-40-12 Ikebukuro, Toshimaku  
 Tokyo, 171-0014, Japan

ビエン・エア・アジア株式会社  
 〒171-0014  
 東京都豊島区池袋2-40-12  
 西池袋第一生命ビルディング10F  
 Tel. +81 (3) 5954-7661  
 Fax +81 (3) 5954-7660  
 ba-asia@bienair.com

**Beijing Bien-Air**  
 Medical Instrument  
 Technology Service Co. Ltd.  
 Room 907, The Exchange Beijing,  
 No 118 Jian Guo Lu Yi,  
 Chao Yang District,  
 Beijing 100022, China  
 北京彼岸医疗器械  
 技术服务有限公司  
 北京市朝阳区建国路  
 乙118号招商局中心  
 京汇大厦2106室  
 Tel. +86 10 6567 0651  
 Fax +86 10 6567 8047  
 ba-beijing@bienair.com