



MAINTENANCE

OF CONTRA-ANGLES AND HANDPIECES FOR SURGERY AND IMPLANTOLOGY.

Refer to the user manual for the product for the complete cleaning and sterilisation maintenance procedures. This medical device is supplied in "non sterile" condition. Please ensure that this procedure is followed before the device is used.

1 PREPARATION



A. REMOVING THE INSTRUMENT

- Remove the rotary instrument from the chuck mechanism
- Disconnect the contra-angle from the motor

B. PRE-DISINFECTION

- External disinfection

⊘ Do not immerse the instrument in a disinfectant bath.

2 CLEANING



A. CLEAN UNDER RUNNING WATER AT <38°C

B. REMOVING DIRT/DEPOSITS / ONLY FOR CA 1:2.5

- Carefully remove all traces of dirt or deposits from the nozzles using the Bien-Air cleaning wire
- Dry the nozzles with compressed air then dry the rest of the instrument with a cloth

⊘ Do not immerse in an ultrasonic cleaner

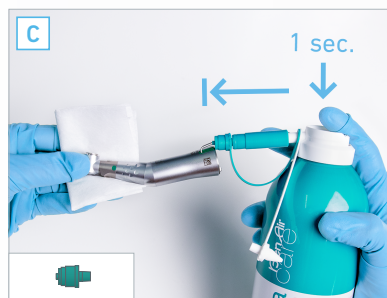
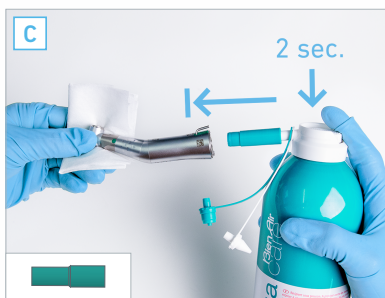

C. INTERNAL CLEANING WITH AQUACARE

- Shake the Aquacare before use
- Use the Aquacare attachment ①*
- Keep the tip of the instrument pointing down and protect with an absorbent cloth; press the Aquacare button down for 2 seconds
- Use the Aquacare attachment ③*
- Keep the tip of the instrument pointing down and protect with an absorbent cloth; press the Aquacare button down for 1 second



D. INTERNAL AND EXTERNAL CLEANING WITH SPRAYNET

- Shake the Spraynet before use
- Use the Spraynet attachment ①*
- Keep the tip of the instrument pointing down and protect with an absorbent cloth; press the Spraynet button down for 1 second
- Clean the exterior of the contra-angle with a cloth soaked in Spraynet

* All the references for the attachments are given on the last page of the document.

3 DISINFECTION

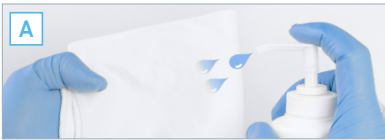

A. DISINFECTION USING SURFACE DISINFECTANT
(follow the manufacturer's instructions for use)

⊘ Do not immerse the instrument in a disinfectant bath

OR

B. THERMAL DISINFECTION
(follow the manufacturer's instructions for use)

4 LUBRICATION



A. LUBRICATION WITH LUBRIFLUID

- Shake the Lubrifluid before use
- Use the Lubrifluid attachment ①*
- Keep the tip of the instrument pointing down and protect with an absorbent cloth; press the Lubrifluid button down for **1 second**
- Then, run an operating test for 30 seconds at a low speed to remove any surplus lubricant
- Store immediately: store the instruments with the tip pointing downwards so that any oil residues can flow out

5 STERILISATION



A. PLACE THE CONTRA-ANGLE IN A STERILISATION BAG

B. STERILISE IN ACCORDANCE WITH THE MANUFACTURER'S INSTRUCTIONS

- Instruments bearing the  symbol can be sterilised in an autoclave

⚠ Only sterilise instruments which have been cleaned and lubricated

* All the references for the attachments are given on the last page of the document.

MAINTENANCE ACCESSORIES



SPRAYNET
500 ml cleaning spray
Pack of 6
REF. 1600036-006

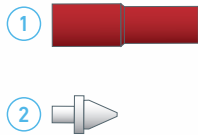

LUBRIFLUID
500 ml lubricant
Pack of 6
REF. 1600064-006

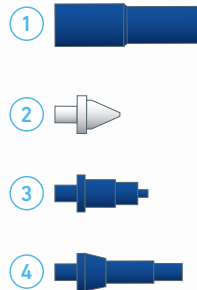

AQUACARE
500 ml cleaning spray
Pack of 6
REF. 1600617-006

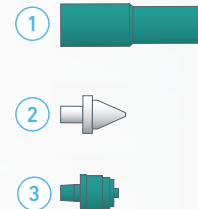

LUBRICARE 2
Maintenance system
REF. 1601156-001



LUBRIMED
Pack of 6 cartridges
REF. 1600037-006



BIEN-AIR CLEANING WIRE
Pack of 10
REF. 1000001-010